

GUIDE TO SUBSIDENCE/HEAVE REPAIR

Definition

The action of stabilising a structure experiencing subsidence (downward movement) or heave (upward movement) by using piling, grouting or stabilisation techniques such as our Hoopsafe® post-tensioned ring beam system.

Types of Subsidence Repair

- Piled rafts
- Steel cased driven piles
- Jack down piles
- Cantilever piles
- Hoopsafe® post-tensioned ring beams
- Screw piles
- Traditional underpinning

Benefits (also see our guide to piling)

Hoopsafe®

- Generally less disruptive than traditional underpinning techniques
- Installation does not require undermining of the structure
- The action of post-tensioning a ring beam around the structure induces compression thereby making the structure stronger and more rigid

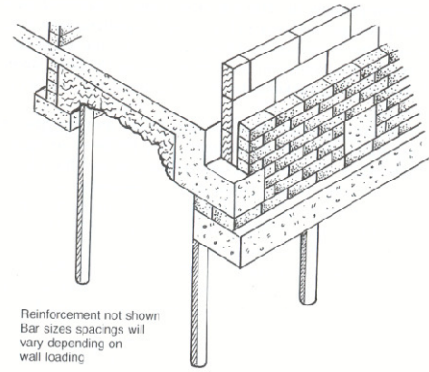

Piled rafts/pin piled slabs

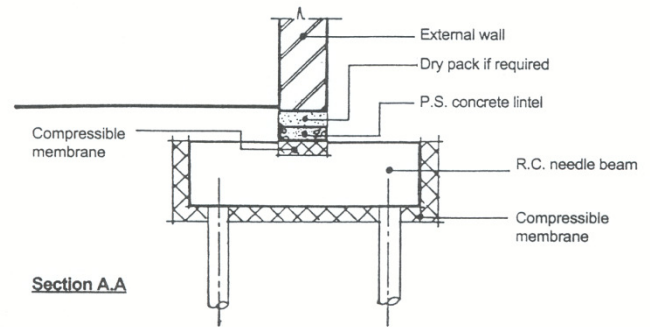

Twin pile and RC needle beams

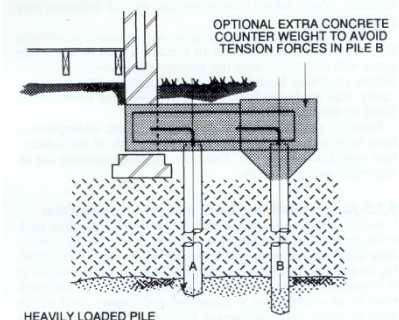

Cantilever needle beams

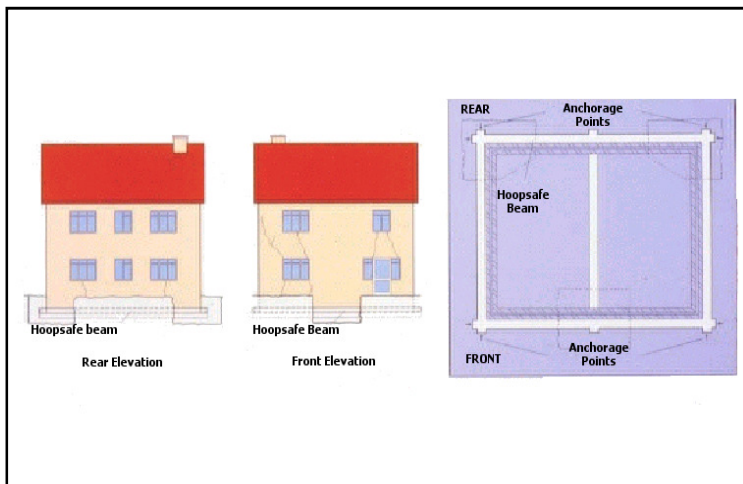

Patented Hoopsafe® method

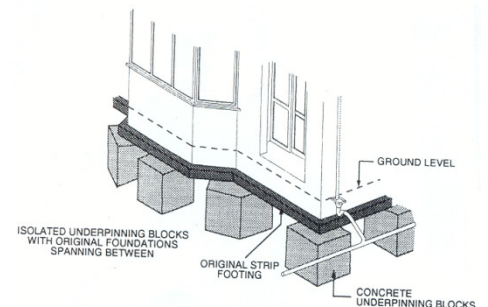

Traditional underpinning